

Alum/Steel Blind Rivet Open End CSK Head DIN7337



Body: Aluminium Alloy (AlMg 2.5%)

Mandrel: Steel Zinc Plated

Mandrel Length: 30mm

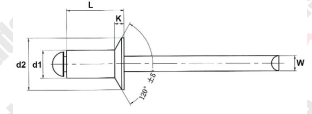

Rivet Dia	Rivet Length		Head Diameter	Head Thickness	Mandrel Diameter	Grip Range	Standard Strength N. (mm)		
d1 dia.	L (mm)	Drill Size	d2 (mm)	K (mm)	w (mm)	mm	SHEAR	TENSILE	Item Code
3.2mm	10.0	3.3mm	6.0 ±0.5	1.3max	1.75 ±0.10	5.0 - 7.0	500	700	ASCSK32010
	12.0					7.0 - 9.0			ASCSK32012
	16.0					11.0 - 13.0			ASCSK32016
4.0mm	8.0	4.2mm	7.5 ±0.5	1.7max	2.15 ±0.10	3.0 - 5.0	850	1200	ASCSK40008
	10.0					5.0 - 6.5			ASCSK40010
	12.0					6.5 - 8.5			ASCSK40012
	16.0					10.5 - 12.5			ASCSK40016
	25.0					15.0 - 20.0			ASCSK40025
4.8mm	12.0	5.0mm	9.0 ±0.5	2.0max	2.65 ±0.10	6.0 - 8.0	1200	1700	ASCSK48012
	16.0					10.0 - 12.0			ASCSK48016
	19.0					12.0 - 15.0			ASCSK48019
	25.0					15.0 - 20.0			ASCSK48025