

# Steel/Steel Blind Rivet Open End Dome Head DIN7337

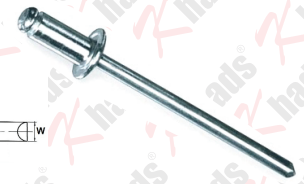

**Body: Low Carbon Steel**  
**Mandrel: Carbon Steel**  
**Mandrel Length: 30mm**

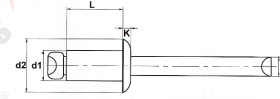

Rivet Dia	Rivet Length		Head Diameter	Head Thickness	Mandrel Diameter	Grip Range	Standard Strength N. (mm)		
d1 dia.	L (mm)	Drill Size	d2 (mm)	K (mm)	W (mm)	mm	SHEAR	TENSILE	Item Code
3.2mm	6.0	3.3mm	6.3 ±0.05	1.1+0 -0.4	1.92±0.10	0.5 - 3.0	1100	1200	STL32006
	8.0					3.0 - 5.0			STL32008
	10.0					5.0 - 6.5			STL32010
	12.0					6.5 - 8.0			STL32012
	16.0					10.0 - 12.0			STL32016
	19.0					12.0 - 16.0			STL32019
	25.0					16.0 - 21.0			STL32025
4.0mm	8.0	4.2mm	8.0 +0-0.5	1.4±0.4	2.35±0.1	3.0 - 5.0	1700	2200	STL40008
	10.0					5.0 - 6.5			STL40010
	12.0					6.5 - 8.0			STL40012
	14.0					8.0 - 10.0			STL40014
	16.0					10.0 - 12.0			STL40016
	19.0					12.0 - 16.0			STL40019
	25.0					16.0 - 20.0			STL40025
4.8mm	8.0	5.0mm	9.5±0.5	1.5±0.4	2.9±0.10	2.5 - 4.0	2900	3100	STL48008
	10.0					4.0 - 6.0			STL48010
	12.0					6.0 - 8.0			STL48012
	14.0					8.0 - 10.0			STL48014
	16.0					10 - 12.0			STL48016
	19.0					12.0 - 15.0			STL48019
	25.0					15.0 - 20.0			STL48025
	30.0					20.5 - 25.0			STL48030
	40.0					29.0 - 34.0			STL48040
	6.4mm					12.0			6.5mm
16.0		6.0 - 9.0	STL64016						
19.0		9.0 - 13.0	STL64019						
25.0		13.0 - 18.0	STL64025						
30.0		18.0 - 23.0	STL64030						
40.0		28.0 - 33.0	STL64040						